

## 大功率电感 GDSPL 系列

### High power inductor GDSPL series

#### 特征 FEATURES

- ◆ 磁屏蔽结构
- ◆ 大电流、低 DCR
- ◆ 复合结构、选材灵活
- ◆ 超低嗡嗡声噪音
- ◆ 在不饱和的情况下处理高瞬态电流峰值

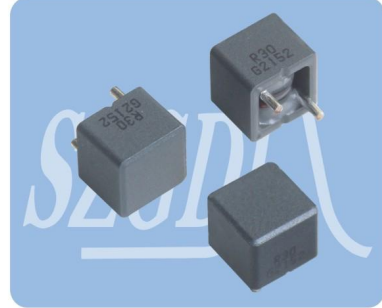

大功率电感 GDSPL 系列

#### 用途 APPLICATIONS

- ◆ 非常适用于电源线 DC-DC 转换应用，尤其适用于电源开关、个人电脑、工业电脑和其他大电流 DC 输出设计。

#### 外观尺寸 External Dimension

注：XXX 表示印字

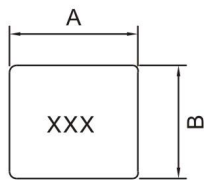

TOP VIEW

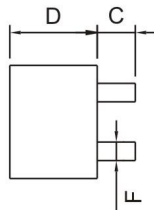

SIDE VIEW

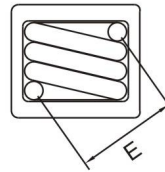

BOTTOM VIEW

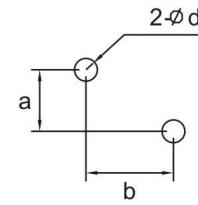

PCB PATTERN

Unit: mm

Series	A	B	C	D	Dimension E / F and PCB Pattern varies with characteristics 尺寸 E / F 和 PCB 图案因特性而异	Material
GDSPL0806P	8.2 Max.	8.2 Max.	3.5 ± 0.5	7.0 Max.		Powder Core
GDSPL1108P	11.7 Max.	11.7 Max.	3.5 ± 0.5	9.5 Max.	Powder Core	
GDSPL1010P	10.5 Max.	10.5 Max.	3.5 ± 0.5	10.0 Max.	Powder Core	
GDSPL1210P	11.5 Max.	11.5 Max.	3.0 ± 0.4	10.0 Max.	Powder Core	
GDSPL1310P	12.5 Max.	12.5 Max.	3.3 ± 0.5	10.0 Max.	Powder Core	

#### 规格命名 SPECIFICATION NAMED

GDSPL    1010    P    -    1R0    M  
①            ②            ③            ④            ⑤

- ① 产品系列 Product Symbol
- ② 产品尺寸 Dimensions
- ③ 基本材料代码 Material Code ( M代表: Ferrite CORE、P代表: IRON Power CORE )
- ④ 标称电感量: 1R0 表示 1.0 μH
- ⑤ 公差: K表示 ±10%, M表示 ±20%, N表示 ±30%

### 规格特性 SPECIFICATIONS

#### GDSPL 0806P 系列

Part Number 型号	Inductance 电感量	DC Resistance 直流电阻	Temperature Rise Current 温升电流	Saturation Current 饱和电流	Dim. E 尺寸 E	Dim. F 尺寸 F	PCB Pattern		
							a	b	ψ d
Units 单位	μH	mΩ	A	A					
GDSPL0806P-R30M	0.30 ± 20%	1.55 ± 8%	31.0	50.0	5.8 ± 0.5	0.9 ± 0.1	3.6 ± 0.5	4.5 ± 0.5	1.2
GDSPL0806P-R36M	0.36 ± 20%	1.55 ± 8%	31.0	45.0	6.3 ± 0.5	0.9 ± 0.1	4.4 ± 0.5	4.5 ± 0.5	1.2
GDSPL0806P-R47M	0.47 ± 20%	1.90 ± 8%	23.0	38.0	6.3 ± 0.5	0.9 ± 0.1	4.4 ± 0.5	4.5 ± 0.5	1.2
GDSPL0806P-R56M	0.56 ± 20%	1.90 ± 8%	23.0	28.0	6.3 ± 0.5	0.9 ± 0.1	4.4 ± 0.5	4.5 ± 0.5	1.2
GDSPL0806P-R82M	0.82 ± 20%	2.90 ± 8%	18.0	23.0	6.2 ± 0.5	0.8 ± 0.1	4.3 ± 0.5	4.5 ± 0.5	1.1
GDSPL0806P-1R0M	1.00 ± 20%	4.30 ± 8%	14.0	22.0	6.2 ± 0.5	0.7 ± 0.1	4.5 ± 0.5	4.4 ± 0.5	1.0
GDSPL0806P-1R2M	1.20 ± 20%	4.30 ± 8%	15.0	20.0	6.2 ± 0.5	0.7 ± 0.1	4.5 ± 0.5	4.4 ± 0.5	1.0

#### GDSPL 1108P 系列

Part Number 型号	Inductance 电感量	DC Resistance 直流电阻	Temperature Rise Current 温升电流	Saturation Current 饱和电流	Dim. E 尺寸 E	Dim. F 尺寸 F	PCB Pattern		
							a	b	ψ d
Units 单位	μH	mΩ	A	A					
GDSPL1108P-R36M	0.36 ± 20%	0.80 ± 8%	38.0	50.0	8.5 ± 0.5	1.5 ± 0.1	5.7 ± 0.5	6.3 ± 0.5	1.8
GDSPL1108P-R47M	0.47 ± 20%	0.80 ± 8%	41.0	50.0	8.5 ± 0.5	1.5 ± 0.1	5.7 ± 0.5	6.3 ± 0.5	1.8
GDSPL1108P-R80M	0.80 ± 20%	1.30 ± 8%	33.0	45.0	9.0 ± 0.5	1.3 ± 0.1	6.4 ± 0.5	6.3 ± 0.5	1.6
GDSPL1108P-1R0M	1.00 ± 20%	1.30 ± 8%	32.0	35.0	9.0 ± 0.5	1.3 ± 0.1	6.4 ± 0.5	6.3 ± 0.5	1.6
GDSPL1108P-1R5M	1.50 ± 20%	1.80 ± 8%	27.0	25.0	9.0 ± 0.5	1.2 ± 0.1	6.4 ± 0.5	6.3 ± 0.5	1.5
GDSPL1108P-2R0M	2.00 ± 20%	3.30 ± 8%	21.0	30.0	9.3 ± 0.5	1.0 ± 0.1	6.6 ± 0.5	6.6 ± 0.5	1.3
GDSPL1108P-3R3M	3.30 ± 20%	6.30 ± 8%	14.0	25.0	9.6 ± 0.5	0.8 ± 0.1	6.6 ± 0.5	7.0 ± 0.5	1.1
GDSPL1108P-4R7M	4.70 ± 20%	9.20 ± 8%	20.0	10.0	9.3 ± 0.5	0.7 ± 0.1	6.4 ± 0.5	6.7 ± 0.5	1.0

#### GDSPL 1010P 系列

Part Number 型号	Inductance 电感量	DC Resistance 直流电阻	Temperature Rise Current 温升电流	Saturation Current 饱和电流	Dim. E 尺寸 E	Dim. F 尺寸 F	PCB Pattern		
							a	b	ψ d
Units 单位	μH	mΩ	A	A					
GDSPL1010P-1R0M	1.00 ± 20%	2.60 ± 8%	23.0	40.0	8.2 ± 0.5	1.0 ± 0.1	5.5 ± 0.5	6.1 ± 0.5	1.3
GDSPL1010P-R56M	0.56 ± 20%	1.05 ± 8%	38.0	50.0	7.8 ± 0.5	1.3 ± 0.1	5.0 ± 0.5	6.0 ± 0.5	1.6

**GDSPL 1210P 系列**

Part Number 型号	Inductance 电感量	DC Resistance 直流电阻	Temperature Rise Current 温升电流	Saturation Current 饱和电流	Dim. E 尺寸 E	Dim. F 尺寸 F	PCB Pattern		
							a	b	ψ d
Units 单位	μH	mΩ	A	A					
GDSPL1210P-R50M	0.50 ± 20%	1.10 ± 8%	37.0	50.0	9.3 ± 0.5	1.3 ± 0.1	6.2 ± 0.5	6.9 ± 0.5	1.6
GDSPL1210P-1R1M	1.10 ± 20%	1.38 ± 8%	25.0	30.0	7.8 ± 0.5	1.3 ± 0.1	6.2 ± 0.5	6.9 ± 0.5	1.6

**GDSPL 1310P 系列**

Part Number 型号	Inductance 电感量	DC Resistance 直流电阻	Temperature Rise Current 温升电流	Saturation Current 饱和电流	Dim. E 尺寸 E	Dim. F 尺寸 F	PCB Pattern		
							a	b	ψ d
Units 单位	μH	mΩ	A	A					
GDSPL1310P-R60M	0.60 ± 20%	0.85 ± 8%	46.0	40.0	9.5 ± 0.5	1.5 ± 0.1	6.0 ± 0.5	7.3 ± 0.5	1.7
GDSPL1310P-1R0M	1.00 ± 20%	1.15 ± 8%	39.0	45.0	9.7 ± 0.5	1.4 ± 0.1	6.9 ± 0.5	6.8 ± 0.5	1.7
GDSPL1310P-1R2M	1.20 ± 20%	1.90 ± 8%	31.0	38.0	10 ± 0.5	1.2 ± 0.1	7.0 ± 0.5	7.1 ± 0.5	1.5

Note:

1. Inductance: 100KHz, 1.0Vrms at 25 °C ambient.
2. DC Resistance: at 25 °C ambient.
3. Temperature Rise Current: DC current for an approximate temperature rise of 40 °C without core loss.
4. Saturation current: DC current for approximately 20% rolloff at 25 °C ambient.

**包装规格 PACKAGING DIMENSIONS**

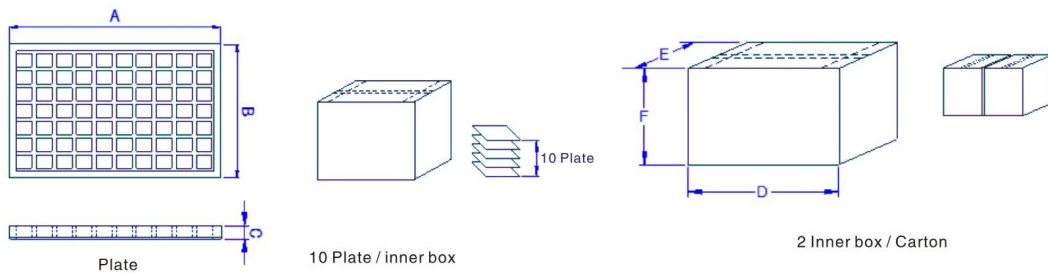

Unit: mm

Series	Plate			Carton			Quantity
	A	B	C	D	E	F	Pcs
SPL0806P	230	150	10	315	250	130	4,000
SPL1108P	230	150	14	315	250	170	2,000
SPL1010P	230	150	14	315	250	170	1,900
SPL1210P	230	150	14	315	250	170	2,000
SPL1310P	230	150	15	315	250	170	2,000